

Environmental Health Section
Beaufort County Health Department
220 N. Market St.
Washington, North Carolina 27889
(252) 946-6048

- New Construction
- Repair
- Existing System

Date: 4-24-01

OPERATION PERMIT

This permit guarantees only materials used and method of installation and that it meets all state regulations for new construction.

Owner: Doug & Pam Block Phone: (252) 894-0083
 Address: 295 Robinson Rd. Washington, NC Lot Number:
 State Road Number: 1601 Type Structure: House
 Septic Tank I.D.: 36" Pump Tank I.D.:
 Installer: Hank Etkes
 Additional for all systems: Landscape system area for surface water runoff and grass.
 Do not place drive or any building over the system area or repair area.
 Remarks: 4-8-05

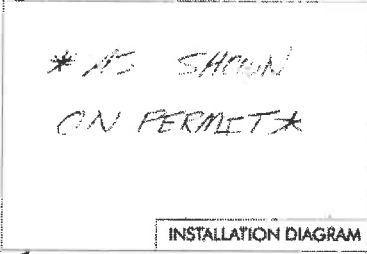

Environmental Health Specialist: Sherry L. Thomas, R.S. Date: 4-24-01
 White — Owner/Contractor Yellow — Health Department Pink — Building Inspections

Permit # 6298

Environmental Health Section
Beaufort County Health Department
220 N. Market St.
Washington, North Carolina 27889
(252) 946-6048
Fax (252) 946-2074
IMPROVEMENTS PERMIT

- New Construction
- Repair
- Existing System

Improvements permits are subject to revocation if the site plans or intended use changes or site alterations occur.

Date: 6-12-2000
 Owner: Doug & Pam Block Phone: (252) 894-0083
 Address: 471 P. Camp Rd. Williamsboro, NC
 Subdivision: Lot Number:
 State Road Number: 1601 Directions: 2045 E. Fran
 Douglas X Rd. 7/2 on SR 1601, property on left side curve
 Property Size: 6.71 ac Type Structure: House
 No. Bedrooms: 3 No. People: 4
 Water Supply: Community (Maintain minimum 10 feet separation from any part of septic system and repair area.)

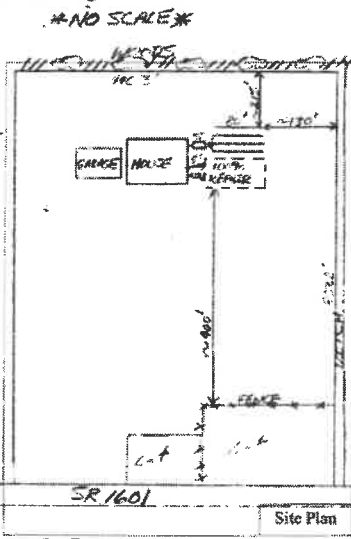

Classification: Suitable Provisionally Suitable PS with fill
 Additional Drainage:
 Seasonal Wetness Condition: 24" Soil Type: H 2 H
 Septic Tank: 1200 gal. Pump Tank: gal.
 Nitrification Field: 760 square feet
 Trench Depth: 12" Fill Depth: 6" typical cover
 Comments: 4 lines of 3" x 8" conventional rock bedding. See note 1 - 1/2" from tank inlet. Foundation. Home location optional on long or gully. Flow to system can be achieved. Observe all proper setbacks.

Additional for all systems: Landscape system area for surface water runoff and grass.
 Do not place drive or any building over the system area or repair area. Observe all proper setbacks (10 NCAC 10A .1950). Do not work soil or install system in wet conditions. This permit must be on site during installation and inspection.

Environmental Health Specialist: Sherry L. Thomas, R.S. Date: 6-12-2000
 White — Owner/Contractor Yellow — Health Department Pink — Building Inspections

AUTHORIZED FOR WASTEWATER SYSTEM CONSTRUCTION

(Authorization For Wastewater System Construction is valid for five years from date of issuance or date of permit).

Owner or Contractor: Doug & Pam Block Phone: (252) 894-0083
 Address:
 Subdivision: Lot Number:
 State Road Number: 1601 Directions:
 Property Size: 6.71 ac Type Structure: House

Environmental Health Specialist: Sherry L. Thomas, R.S. Date: 6-12-2000
 White — Owner/Contractor Yellow — Health Department Pink — Building Inspection