

Building Sketch (Page - 1)

Borrower				
Property Address	245 Roberson Rd			
City	Washington	County	State	NC Zip Code 27889
Lender/Client				

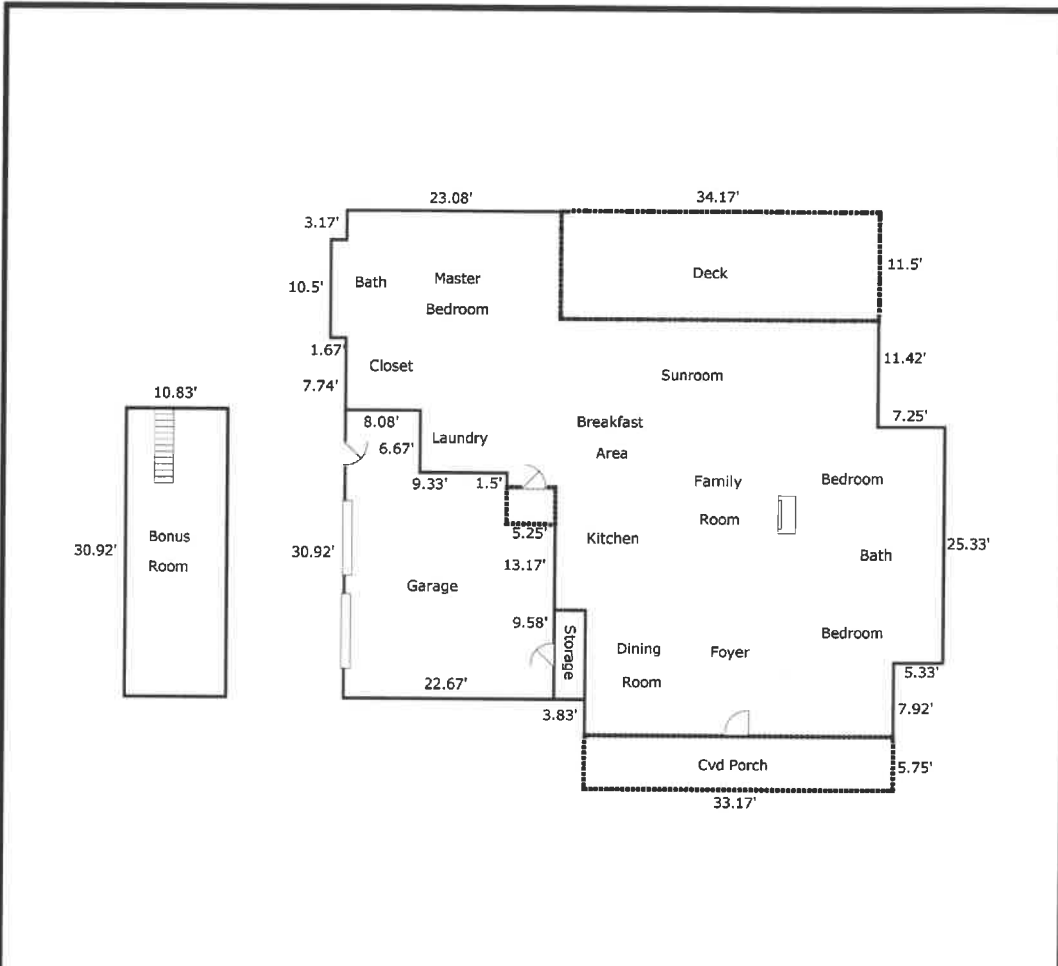

Area Calculations Summary

Living Area		Calculation Details
Storage	-31.94 Sq ft	9.58 × 3.33 = 31.94
First Floor	2311.38 Sq ft	10.5 × 1.67 = 17.5 23.08 × 11.5 = 265.46 9.91 × 8.08 = 80.11 16.58 × 9.33 = 154.72 18.08 × 5.25 = 94.9 34.58 × 11.42 = 394.83 41.83 × 19.83 = 829.55 5.5 × 5.33 = 29.33 13.42 × 33.17 = 444.99
Garage	-595.76 Sq ft	22.67 × 22.75 = 515.74 8.17 × 8.08 = 66.01 9.33 × 1.5 = 14
Bonus Room	334.97 Sq ft	30.92 × 10.83 = 334.97
Total Living Area (Rounded):	2646 Sq ft	
Non-living Area		
Covered Front Porch	190.71 Sq ft	33.17 × 5.75 = 190.71
Deck	392.92 Sq ft	11.5 × 34.17 = 392.92
Stoop	21 Sq ft	5.25 × 4 = 21

Building Sketch (Page - 2)

Borrower			
Property Address	245 Roberson Rd		
City	Washington	County	State NC Zip Code 27889
Lender/Client			

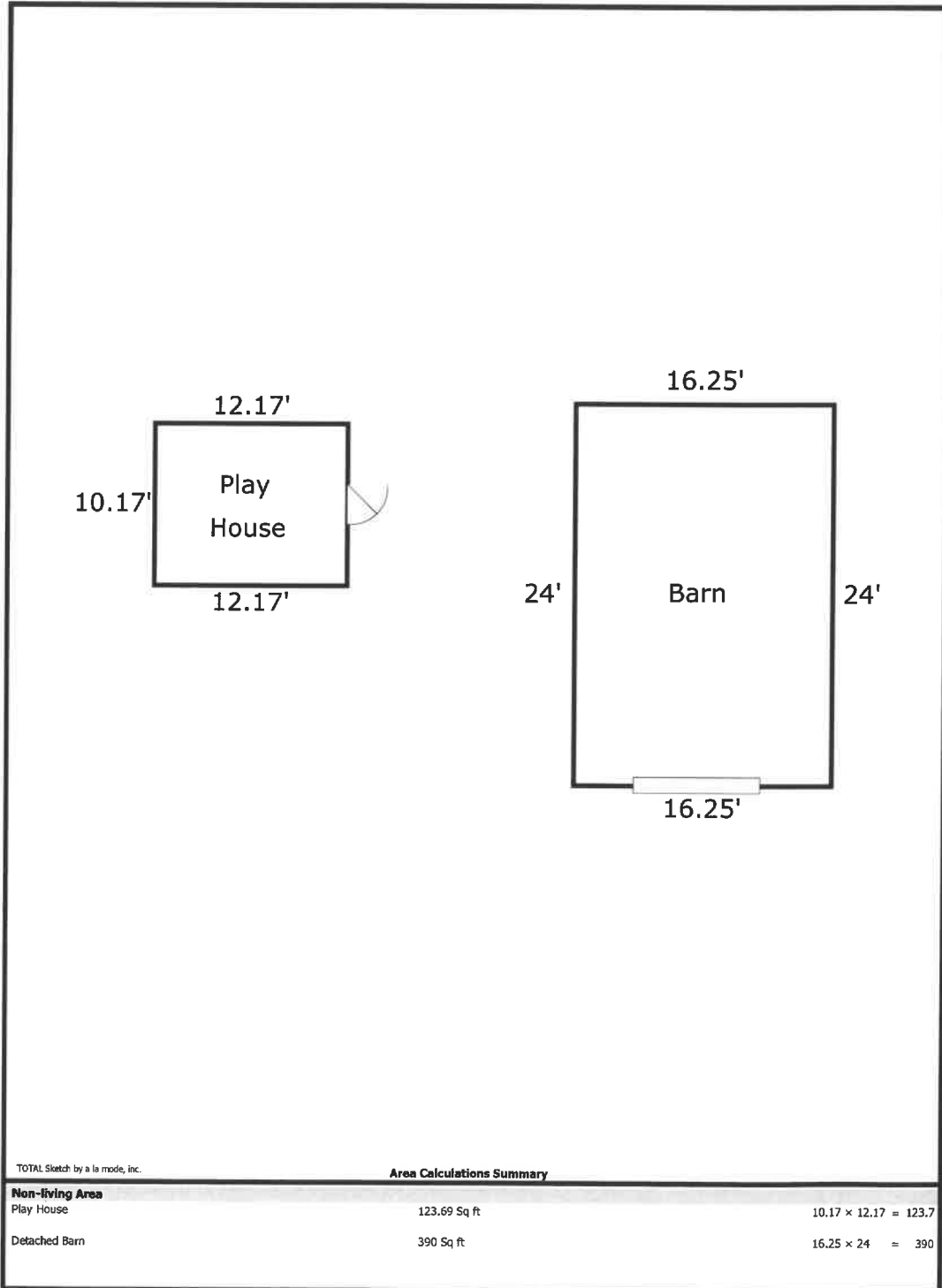

Supplemental Addendum

File No: Wilder01/23/19

Borrower				
Property Address	245 Roberson Rd			
City	Washington	County	State	NC Zip Code 27889
Lender/Client				

245 Roberson Road
Washington, NC 27889

Foyer	12'2" X 10'2"
Dining Room	12'4" X 12'10"
Family Room	15'6" X 18'9"
Kitchen & Breakfast Area	12' X 21'6"
Bedroom	12'10" X 11'
Bedroom	11'1" X 12'7"
Master Bedroom	13'11" X 16'6"
Laundry Room	5'2" X 5'9"
Sunroom	34'2" X 11'6"
Bonus Room	10'10" X 30.92'
Garage (Irregular)	30.92' X 22'8"

Signature _____	Signature _____
Name _____	Name _____
Date Signed _____	Date Signed _____
State Certification # _____ State _____	State Certification # _____ State _____
Or State License # _____ State _____	Or State License # _____ State _____